

Vacuum Check Valve VT-1H with level compensator, G threads, Lock pin 16, Left hand connection

Item number: X6015LH

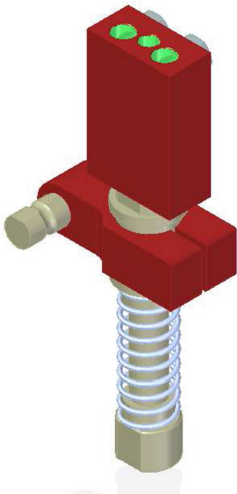

- Check valve that traps vacuum in sealed applications for safe operation.
- Built-in blow off check valve for fast release of object.
- Available in lock pin 16, 19 or ball joint mountings, industry standard.
- Available with level compensator to compensate for differences in level of object.
- Recommend using 4mm (5/32") tubing and no more than 80 psi for blow off.
- Recommend using 6mm (1/4") tubing and no more than 80 psi for vacuum.
- Equal line lengths from common manifold should be used for both blow-off and vacuum.
- Maximum of (12) units per tool.

Technical data

Description	Unit	Value
Material	-	Al, Ceramic, CuZn, Nitrile (NBR), Polyurethane (PU), SS, Steel
Load, vertical, max.	lbf	157.37
Temperature, max.	°F	158.0
Temperature, min.	°F	-22.0
Weight, max.	oz	56.88
Weight, min.	oz	54.062
Feed pressure, max. (blow-off)	psi	0.080
Feed pressure, min. (breakaway blow-off)	psi	0.036
Noise level, max.	dBA	68
Noise level, min.	dBA	66
Vacuum flow, range, max.	scfm	1.44
Life span (at max load)	cycles	10000000
Volume, internal (level compensator)	in³	0.84
Action range	°	0-360
Action range/Stroke	in	1.97
Spring force, max.	lbf	14.99

Dimensional drawings

