

Suction cup OBF40X80P Polyurethane 60, G1/4” male

Item number: OBF40x80P.5X.G14M

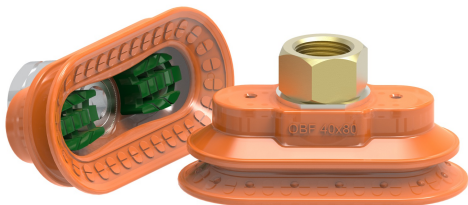

- Special designed friction cups for oily surfaces, such as sheets in metal forming processes.
- Normal wear on friction cup will not affect the long term shear force performance.
- Best choice if > 0,1g/m2 press oil is used on the sheet.
- Thanks to the strong grip on oily surfaces, the suction cups can withstand high shear forces, typically 2–4 times more than corresponding conventional suction cups.
- The "OBF" design is suitable for oblong objects with domed and flat surfaces, such as those encountered with body parts in the automotive industry.
- Can handle objects with height differences.
- Fitting option, male G3/8", with a swivel function prior to the locking operation, for easy positioning of the oval cup.
- DURAFLEX® suction cups manufactured in a specially developed material that features the elasticity of rubber and wear resistance of polyurethane. The material does not leave any marks on the objects handled.

Technical data

| Description | Unit | Value |
|--------------------------|------|-----------------------------------|
| Suction cup shape | - | Bellows |
| Application | - | Oily sheet metal, Dry sheet metal |
| Suction cup design | - | Oval |
| Characteristics | - | Oily sheet metal, Dry sheet metal |
| Material | - | Polyurethane (PU) |
| Weight, min. | oz | 2.17 |
| Suction cup model | - | OBF |
| Volume | in³ | 1.36 |
| Height | in | 1.56 |
| Height 2 (Actuated) | in | 1.23 |
| Length | in | 3.12 |
| Outer diameter, min. | in | 1.58 |
| Outer diameter, actuated | in | 1.54 |
| Fitting size | - | 1/4" |
| Fitting option | - | None |
| Fitting style | - | Male |
| Fitting type | - | G-thread |
| Width | in | 1.58 |
| Length, actuated | in | 3.17 |
| Fitting material | - | Polyurethane (PU60) |
| Suction cup model | - | OBF40x80P Dry metal sheet |
| Movement, vertical max. | in | 0.33 |
| Curve radius, min. | in | 2.17 |
| Suction cup model | - | OBF40x80P Oily steel plate |
| Movement, vertical max. | in | 0.33 |

Performance - Lifting forces

| | | |
|----------------------------|---------------|---------------|
| OBF40x80P Dry metal sheet | Vertical (lb) | Parallel (lb) |
| 17.72 -inHg | 16.19 | 9.89 |
| 26.58 -inHg | 23.83 | 12.14 |
| OBF40x80P Oily steel plate | | |
| 17.72 -inHg | 16.19 | 5.62 |
| 26.58 -inHg | 22.93 | 7.19 |

Dimensional drawings

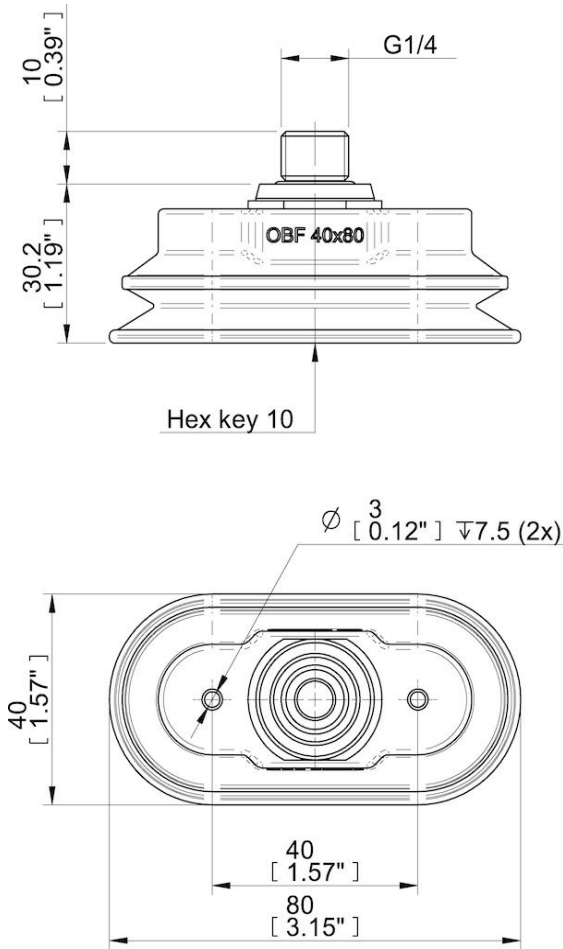

Values specified in this data sheet are tested at (unless otherwise stated):

- Room temperature (20°C [68°F] ± 3°C [5.5°F]).
- Standard atmosphere (101.3 [29.9 inHg] ± 1.0 kPa [0.3 inHg]).
- Relative humidity 20-70%.
- Compressed air quality, DIN ISO 8573-1 class 4.