

# Suction cup F30-2 Silicone FCM, G1/8" male/M5 female, with mesh filter

Item number: F30-2.21.02AF



- The silicone material complies with FDA 21 CFR 177.2600 & EU 1935/2004.
- Suitable for flat objects.
- Good stability and little inherent movement.
- Recommended when the lifting force is parallel to the surface of the object.
- Cleats prevent thin, sensitive objects from being deformed and gives extra friction when the lifting force is parallel.

Technical data

| Description              | Unit            | Value   |
|--------------------------|-----------------|---|
| Suction cup shape        | -               | Flat  |
| Application              | -               | Food contact materials (FDA & EU), non-detectable |
| Suction cup design       | -               | Round   |
| Characteristics          | -               | Food contact materials (FDA & EU), non-detectable |
| Material                 | -               | Silicone (SIL)                                    |
| Weight, min.             | oz              | 0.078   |
| Suction cup model        | -               | F   |
| Volume                   | in <sup>3</sup> | 0.12  |
| Height                   | in              | 0.70  |
| Outer diameter, min.     | in              | 1.26  |
| Outer diameter, actuated | in              | 1.28  |
| Fitting size             | -               | 1/8", M5  |
| Fitting option           | -               | Filter mesh                                       |
| Fitting style            | -               | Female/Male                                       |
| Fitting type             | -               | G-thread, M-thread                                |
| Suction cup model        | -               | F30-2   |
| Movement, vertical max.  | in              | 0.11  |
| Curve radius, min.       | in              | 0.98  |

Performance - Lifting forces

| F30-2       | Vertical (lb) | Parallel (lb) |
|-------------|---------------|---------------|
| 5.91 -inHg  | 2.70          | 2.47          |
| 17.72 -inHg | 5.62          | 3.60          |
| 26.58 -inHg | 6.97          | 4.50          |

|                        |                              |
|------------------------|------------------------------|
| <b>Material</b>        |                              |
| Name                   | Silicone (SIL FDA) 50° Shore |
| Color                  | Transparent                  |
| Temperature, min.   °F | -40.0                        |
| Temperature max.   °F  | 392.0                        |
| Hardness   °Shore A    | 50                           |

|                            |           |
|----------------------------|-----------|
| <b>Material resistance</b> |           |
| Alcohol                    | Good      |
| Concentrated acids         | Poor      |
| Ethanol                    | n/a       |
| Hydrolysis                 | Fair      |
| Methanol                   | n/a       |
| Oil                        | Poor      |
| Oxidation                  | Excellent |
| Gasoline                   | Poor      |
| Wear resistance            | Good      |
| Weather and ozone          | Excellent |

Dimensional drawings

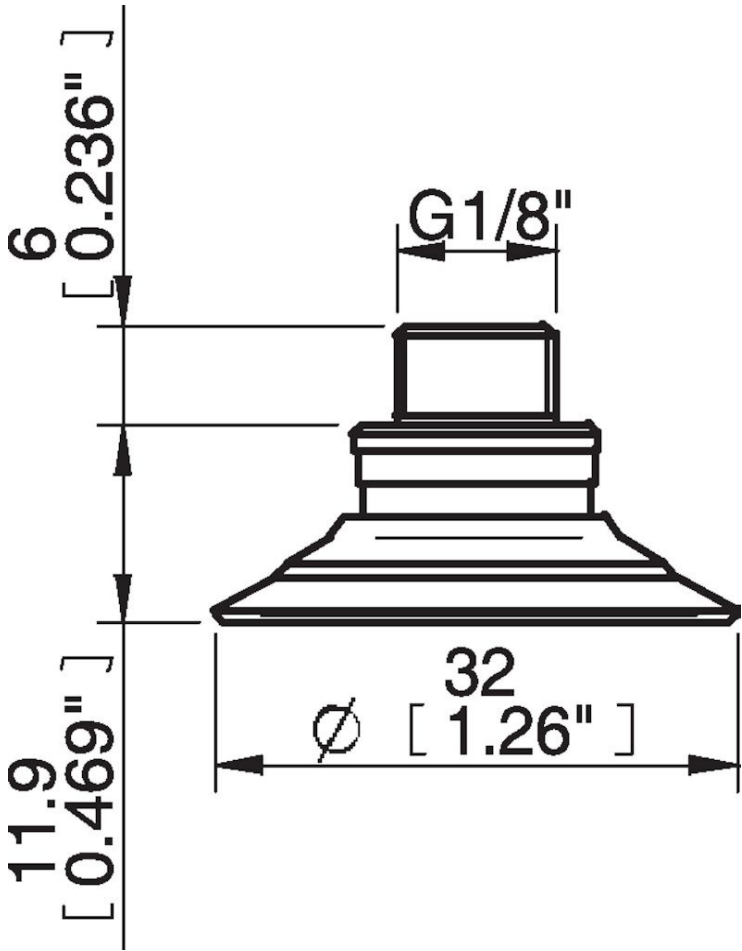

Values specified in this data sheet are tested at (unless otherwise stated):

- Room temperature (20°C [68°F] ± 3°C [5.5°F]).
- Standard atmosphere (101.3 [29.9 inHg] ± 1.0 kPa [0.3 inHg]).
- Relative humidity 20-70%.
- Compressed air quality, DIN ISO 8573-1 class 4.

**Accessories**

02AB | Fitting G1/8" male, with mesh filter

024C | Fitting 1/8" NPT male, with mesh filter

**Spare parts**

02AF | Fitting G1/8" male/M5 female, with mesh filter

F30-2.21 | Suction cup F30-2 Silicone FCM