

# Suction cup DCF100P Polyurethane 60, T-slot with mesh filter

Item number: DCF100P.5Y.T2MR



Technical data

Description	Unit	Value
Suction cup shape	-	Deep Concave
Application	-	Oily sheet metal
Suction cup design	-	Round
Characteristics	-	Oily sheet metal
Material	-	Polyurethane (PU)
Weight, min.	oz	2.85
Suction cup model	-	DCF
Volume	in <sup>3</sup>	3.60
Height	in	1.51
Height 2 (Actuated)	in	1.035
Outer diameter, min.	in	3.95
Outer diameter, actuated	in	4.13
Fitting option	-	Filter mesh
Fitting style	-	T-slot
Fitting material	-	Al (anodized)
Suction cup model	-	DCF100 Dry metal sheet
Movement, vertical max.	in	0.47
Curve radius, min.	in	2.76
Suction cup model	-	DCF100 Oily metal sheet
Movement, vertical max.	in	0.47
Curve radius, min.	in	2.76

Performance - Lifting forces

DCF100 Dry metal sheet	Vertical (lb)	Parallel (lb)
17.72 -inHg	55.98	60.47
26.58 -inHg	75.31	92.85
DCF100 Oily metal sheet		
17.72 -inHg	53.50	42.26
26.58 -inHg	72.84	58.45

<b>Material</b>	
Name	Polyurethane (PU60)
Color	Orange
Temperature, min.   °F	50.0
Temperature max.   °F	122.0
Hardness   °Shore A	60
<b>Material resistance</b>	
Alcohol	n/a
Concentrated acids	Fair
Ethanol	Fair
Hydrolysis	Fair
Methanol	Poor
Oil	Excellent
Oxidation	Poor
Gasoline	Fair
Wear resistance	Excellent
Weather and ozone	Excellent

Dimensional drawings

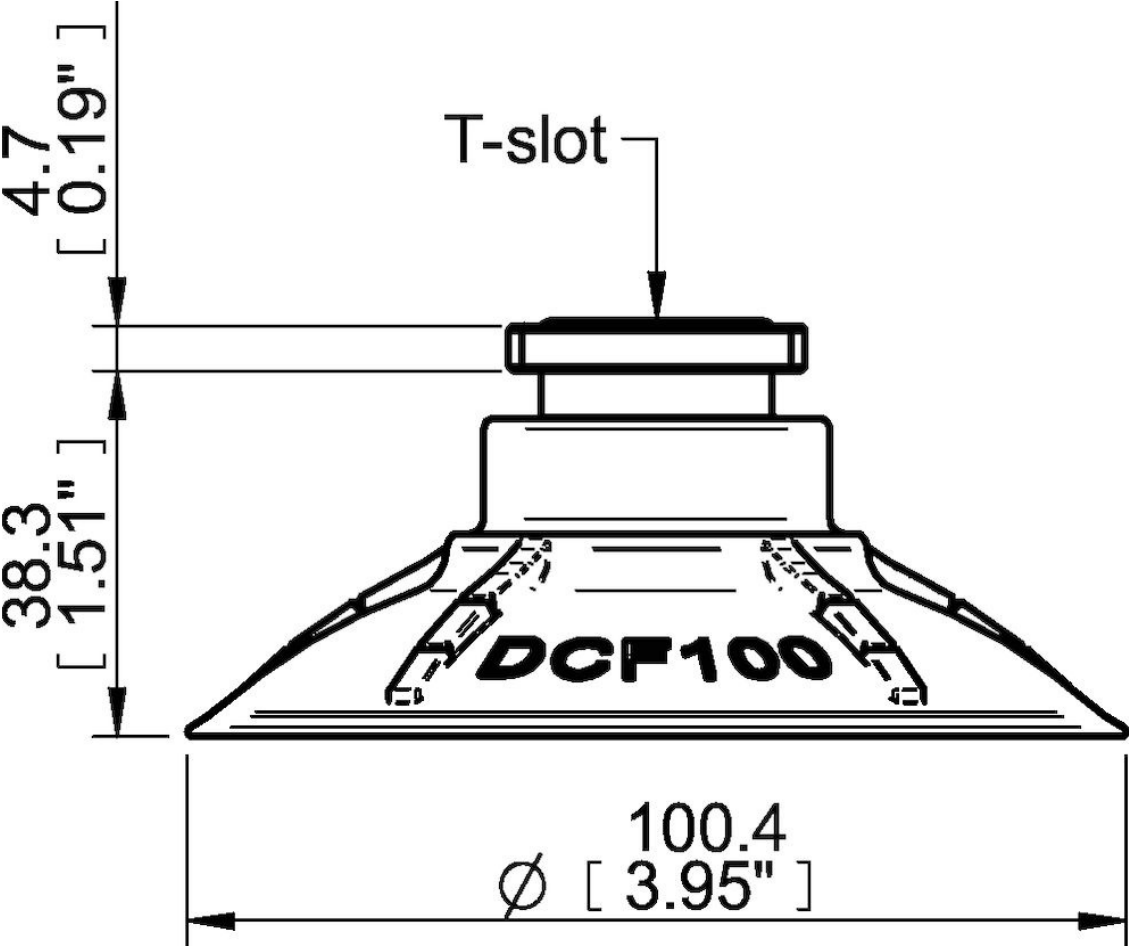

Values specified in this data sheet are tested at (unless otherwise stated):

- Room temperature (20°C [68°F] ± 3°C [5.5°F]).
- Standard atmosphere (101.3 [29.9 inHg] ± 1.0 kPa [0.3 inHg]).
- Relative humidity 20-70%.
- Compressed air quality, DIN ISO 8573-1 class 4.