

# Suction cup BX20P Polyurethane 30/60, G1/8" male / M5 female, with dual flow control valve

Item number: BX20P.4K.02DD



- Suitable for level adjustment and for uneven and porous surfaces such as cardboard, etc.
- Dual hardness allowing strength and stability in conjunction with softness and flexibility.
- DURAFLEX® material features the elasticity of rubber in combination with the wear resistance of polyurethane.
- The DURAFLEX® material is mark-free.

Technical data

Description	Unit	Value
Suction cup shape	-	Multibellows
Application	-	Dry sheet metal, Corrugated cardboard/Paperboard, Mark Free, Plastic injection molded parts
Suction cup design	-	Round
Characteristics	-	Dry sheet metal, Corrugated / cardboard, Mark free, Plastic injection molded parts
Material	-	Polyurethane (PU)
Weight, min.	oz	0.050
Suction cup model	-	BX-P
Volume	in³	0.071
Leakage flow, max.	scfm	0.13
Height	in	0.89
Outer diameter, min.	in	0.83
Fitting size	-	1/8", M5
Fitting option	-	Dual flow control valve
Fitting style	-	Female/Male
Fitting type	-	G-thread, M-thread
Valve restriction	in	0.028
Restricted vacuum flow	scfm	1.48
Suction cup model	-	BX20P PU30 PU60
Movement, vertical max.	in	0.30
Curve radius, min.	in	0.39

Performance - Lifting forces

BX20P PU30 PU60	Vertical (lb)	Parallel (lb)
5.91 -inHg	1.012	0.90
17.72 -inHg	1.57	1.26
26.58 -inHg	2.14	1.46

<b>Material</b>		
Name	Polyurethane (PU30)	Polyurethane (PU60)
Color	Yellow	Green transparent
Temperature, min.   °F	50.0	50.0
Temperature max.   °F	122.0	122.0
Hardness   °Shore A	30	60
<b>Material resistance</b>		
Alcohol	n/a	n/a
Concentrated acids	Fair	Fair
Ethanol	Fair	Fair
Hydrolysis	Fair	Fair
Methanol	Poor	Poor
Oil	Excellent	Excellent
Oxidation	Poor	Poor
Gasoline	Fair	Fair
Wear resistance	Excellent	Excellent
Weather and ozone	Excellent	Excellent

Dimensional drawings

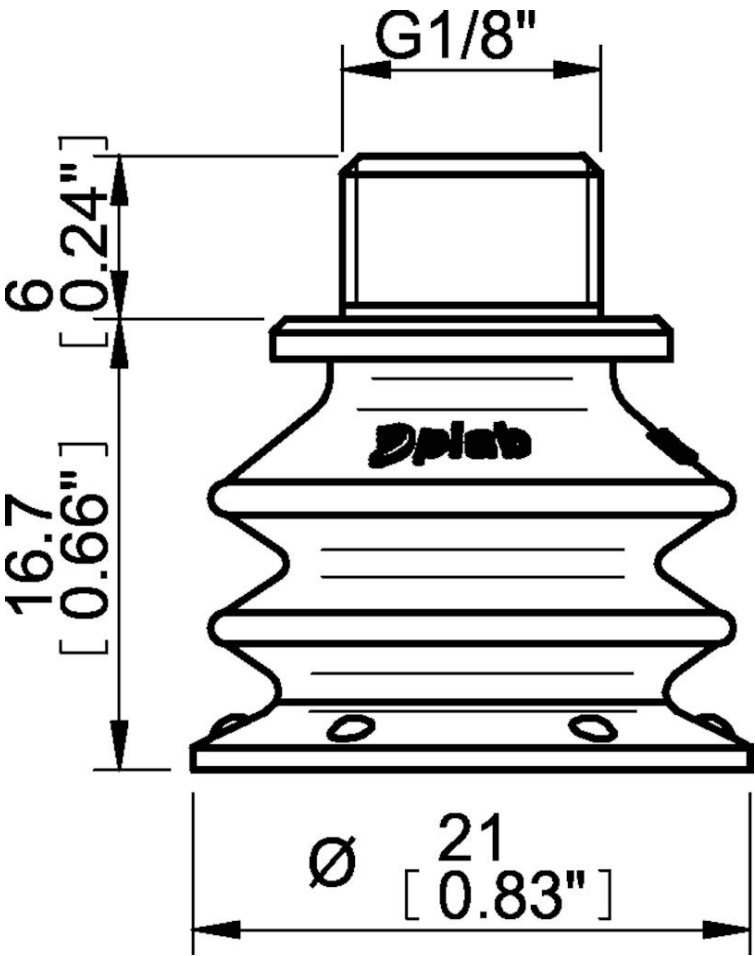

Values specified in this data sheet are tested at (unless otherwise stated):

- Room temperature (20°C [68°F] ± 3°C [5.5°F]).
- Standard atmosphere (101.3 [29.9 inHg] ± 1.0 kPa [0.3 inHg]).
- Relative humidity 20-70%.
- Compressed air quality, DIN ISO 8573-1 class 4.

### **Accessories**

02AE | Fitting 5xM5 female

02AF | Fitting G1/8" male/M5 female, with mesh filter

BX20P.4E | Suction cup BX20P Polyurethane 60

02AA | Fitting M5 female

02AB | Fitting G1/8" male, with mesh filter

02AC | Fitting 1/8" NPT male, with mesh filter

### **Spare parts**

BX20P.4K | Suction cup BX20P Polyurethane 30/60

02DD | Fitting G1/8" male/M5 female, with dual flow control valve