

# Suction cup BFFT80P-2 Polyurethane 60/60/30, G1/4" female, with mesh filter

Item number: BFFT80P306060.G14F.01



Technical data

Description	Unit	Value
Suction cup shape	-	Bellows
Application	-	Oily sheet metal, Dry sheet metal
Suction cup design	-	Round
Characteristics	-	Oily sheet metal, Dry sheet metal
Material	-	Polyurethane (PU)
Weight, min.	oz	2.15
Suction cup model	-	BFFT
Volume	in <sup>3</sup>	4.94
Height	in	1.54
Height 2 (Actuated)	in	0.70
Outer diameter, min.	in	3.26
Outer diameter, actuated	in	3.40
Fitting size	-	1/4"
Fitting option	-	Filter mesh
Fitting style	-	Female
Fitting type	-	G-thread
Suction cup model	-	BFFT80P-2 Oily metal sheet
Movement, vertical max.	in	0.83
Curve radius, min.	in	4.33
Suction cup model	-	BFFT80P-2 Dry metal sheet
Movement, vertical max.	in	0.83
Curve radius, min.	in	4.33

Performance - Lifting forces

	Vertical (lb)	Parallel (lb)
BFFT80P-2 Oily metal sheet		
5.91 -inHg	19.56	9.89
11.81 -inHg	36.64	16.64
17.72 -inHg	54.40	22.93
26.58 -inHg	63.40	31.92
BFFT80P-2 Dry metal sheet		
5.91 -inHg	19.56	13.49
11.81 -inHg	36.64	29.00049
17.72 -inHg	54.40	42.26
26.58 -inHg	63.40	46.76

Material			
Name	Polyurethane (PU30)	Polyurethane (PU60)	Polyurethane (PU60)
Color	Yellow	Green transparent	Orange
Temperature, min.   °F	50.0	50.0	50.0
Temperature max.   °F	122.0	122.0	122.0
Hardness   °Shore A	30	60	60

Material resistance

Alcohol	n/a	n/a	n/a
Concentrated acids	Fair	Fair	Fair
Ethanol	Fair	Fair	Fair
Hydrolysis	Fair	Fair	Fair
Methanol	Poor	Poor	Poor
Oil	Excellent	Excellent	Excellent
Oxidation	Poor	Poor	Poor
Gasoline	Fair	Fair	Fair
Wear resistance	Excellent	Excellent	Excellent
Weather and ozone	Excellent	Excellent	Excellent

Dimensional drawings

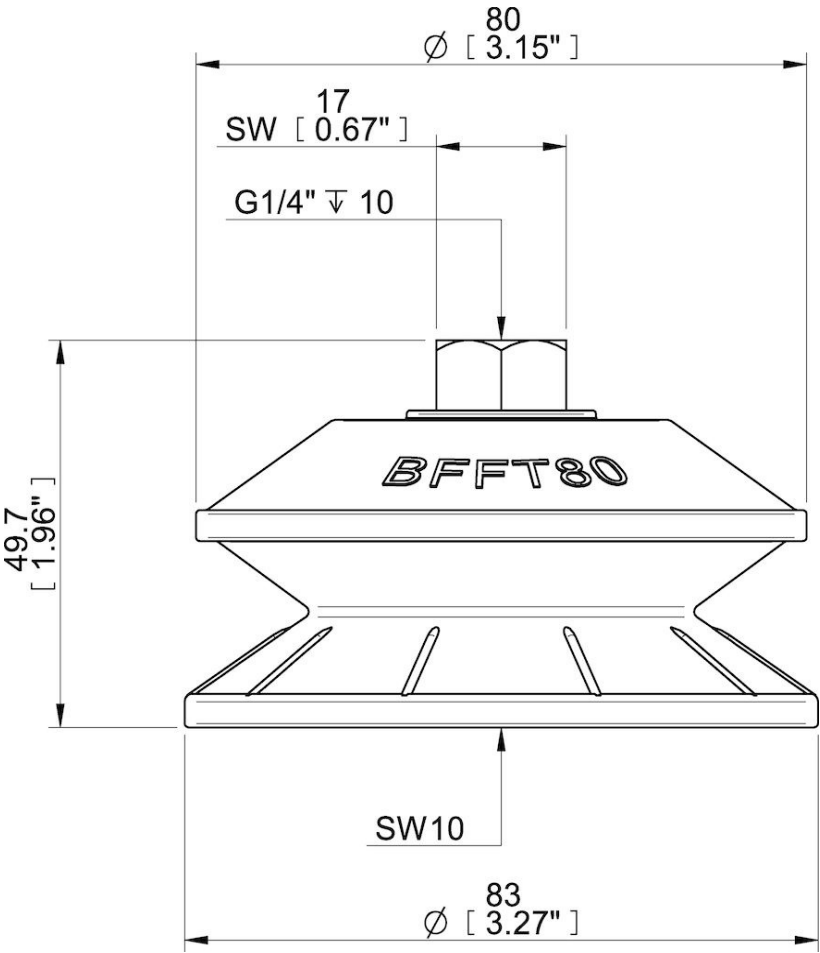

Values specified in this data sheet are tested at (unless otherwise stated):

- Room temperature (20°C [68°F] ± 3°C [5.5°F]).
- Standard atmosphere (101.3 [29.9 inHg] ± 1.0 kPa [0.3 inHg]).
- Relative humidity 20-70%.
- Compressed air quality, DIN ISO 8573-1 class 4.