

# Suction cup B50 Silicone, G3/8" male, with mesh filter

Item number: B50.20.05AD



- Suitable for level adjustment. Several short bellows in one lifting device can handle objects with height differences and varying shapes, for example embossed or corrugated plates.
- The lifting movement can be used to separate small and thin objects.
- Only lightweight objects should be handled when the lifting force is parallel to the surface of the object, in order to achieve good precision and safe lifting movement.

Technical data

| Description              | Unit            | Value   |
|--------------------------|-----------------|---|
| Suction cup shape        | -               | Bellows   |
| Application              | -               | Dry sheet metal, Plastic injection molded parts |
| Suction cup design       | -               | Round   |
| Characteristics          | -               | Dry sheet metal, Plastic injection molded parts |
| Material                 | -               | Silicone (SIL)                                  |
| Weight, min.             | oz              | 0.71  |
| Suction cup model        | -               | B   |
| Volume                   | in <sup>3</sup> | 1.95  |
| Height                   | in              | 2.020   |
| Outer diameter, min.     | in              | 2.11  |
| Outer diameter, actuated | in              | 2.36  |
| Fitting size             | -               | 3/8"  |
| Fitting option           | -               | Filter mesh                                     |
| Fitting style            | -               | Male  |
| Fitting type             | -               | G-thread  |
| Suction cup model        | -               | B50   |
| Movement, vertical max.  | in              | 0.72  |
| Curve radius, min.       | in              | 1.18  |

Performance - Lifting forces

| B50         | Vertical (lb) | Parallel (lb) |
|-------------|---------------|---------------|
| 5.91 -inHg  | 7.42          | 5.44          |
| 17.72 -inHg | 14.61         | 11.51         |
| 26.58 -inHg | 18.43         | 13.67         |

| Material               |                           |
|------------------------|---------------------------|
| Name                   | Silicone, SIL 50° Shore A |
| Color                  | Red                       |
| Temperature, min.   °F | -40.0                     |
| Temperature max.   °F  | 392.0                     |
| Hardness   °Shore A    | 50                        |

Material resistance

|                    |           |
|--------------------|-----------|
| Alcohol            | Good      |
| Concentrated acids | Poor      |
| Ethanol            | n/a       |
| Hydrolysis         | Fair      |
| Methanol           | n/a       |
| Oil                | Poor      |
| Oxidation          | Excellent |
| Gasoline           | Poor      |
| Wear resistance    | Good      |
| Weather and ozone  | Excellent |

Dimensional drawings

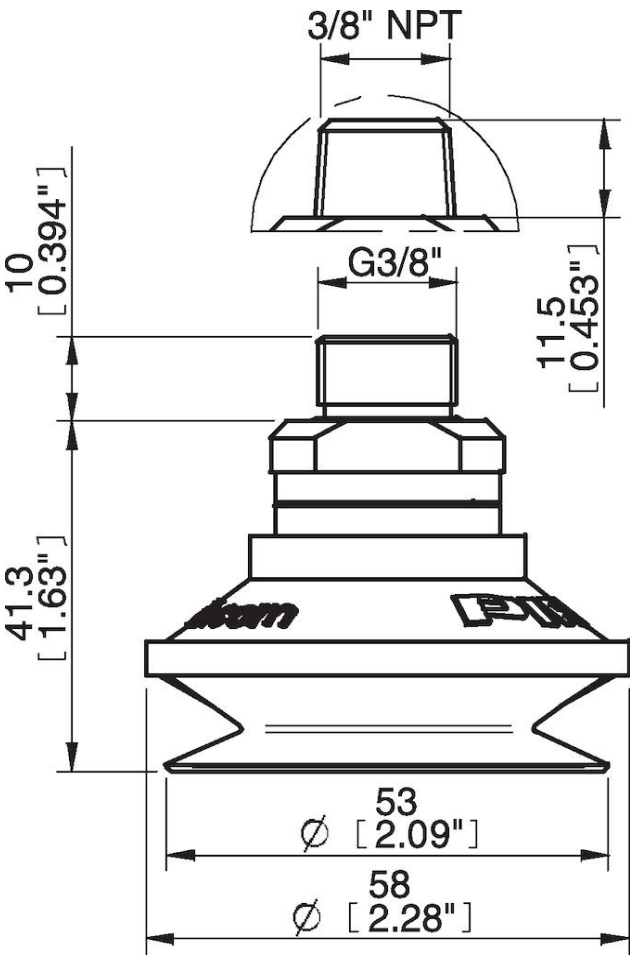

Values specified in this data sheet are tested at (unless otherwise stated):

- Room temperature (20°C [68°F] ± 3°C [5.5°F]).
- Standard atmosphere (101.3 [29.9 inHg] ± 1.0 kPa [0.3 inHg]).
- Relative humidity 20-70%.
- Compressed air quality, DIN ISO 8573-1 class 4.

### **Accessories**

05AF | Fitting 5x1/8" NPSF female, 50  
B50.30 | Suction cup B50 Nitrile-PVC  
05AG | Fitting 1/8" NPSF female, 50, with mesh filter  
B50.37 | Suction cup B50 HNBR  
05AI | Fitting G1/8" male, 50, with mesh filter  
05CA | Fitting 1/8" NPSF female, 50, PA  
05AA | Fitting 1/8" NPSF female, 50  
05AE | Fitting 3/8" NPT male, with mesh filter  
05AB | Fitting G1/4" male, 50, with mesh filter  
05AC | Fitting 1/4" NPT male, with mesh filter  
05DA | Fitting 1/8" NPSF female, 50, with dual flow control valve  
05DB | Fitting G1/4" male, with dual flow control valve  
05DC | Fitting 1/4" NPT male, with dual flow control valve  
05DD | Fitting G3/8" male, 50, with mesh filter and dual flow control valve  
05DE | Fitting 3/8" NPT male, with dual flow control valve  
05DF | Fitting 5x1/8" NPSF female, 50, with dual flow control valve

### **Spare parts**

B50.20 | Suction cup B50 Silicone  
05AD | Fitting G3/8" male, 50, with mesh filter